

SPECIFICATION MODEL: "SL19" SERIES

6A 120VAC, 3A 250VAC (UL)  
 6A 28VAC (UL)  
 INITIAL CONTACT RESISTANCE : 10mΩ (max)  
 INSULATION RESISTANCE: 500VDC 100MΩ (min)  
 DIELECTRIC STRENGTH: 1,000VAC FOR 1 MINUTE  
 LIFE CYCLE : 30,000 CYCLES  
 TEMPERATURE RANGE: -20°C TO 85°C  
 CASE: DIALYL PHTHALATE (DAP)  
 HOUSING: STAINLESS STEEL  
 SLIDE HANDLE: NYLON66  
 CONTACT: COIN SILVER, SILVER PLATED  
 CENTER CONTACT & TERMINALS : BRASS SILVER PLATED

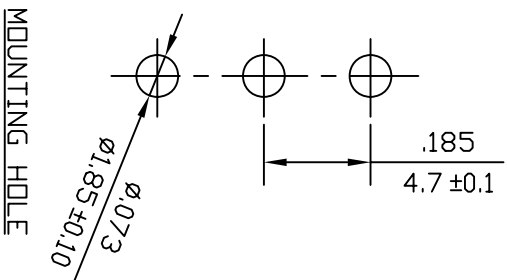
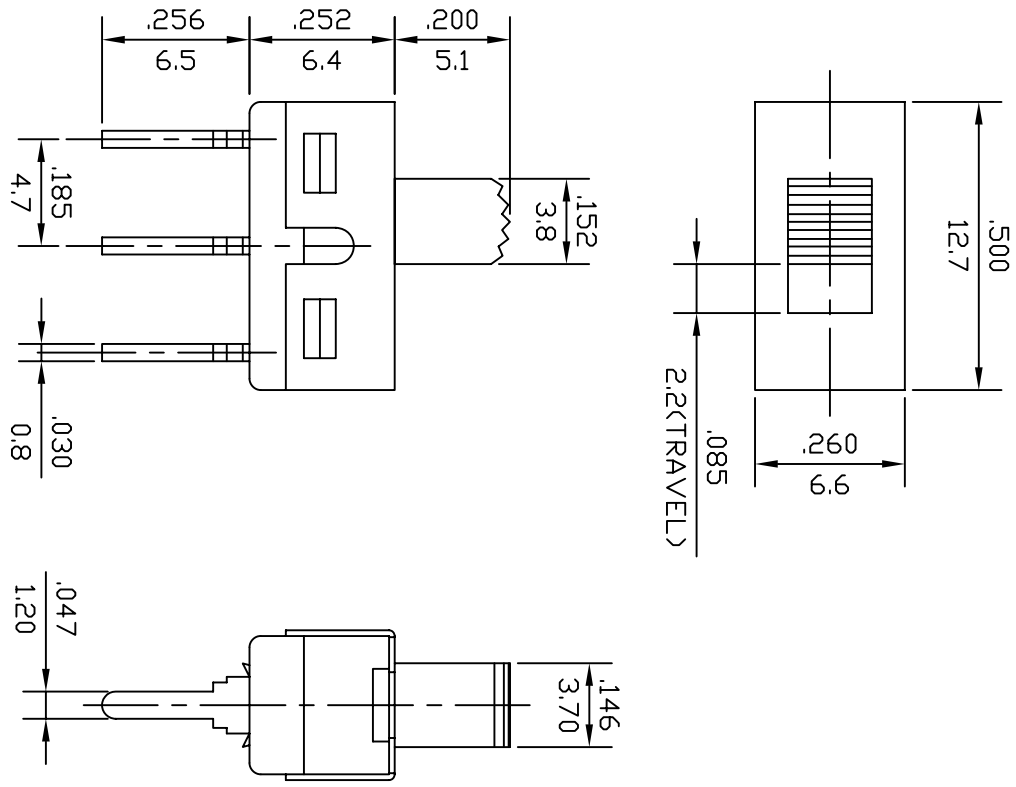

REVISION	DESCRIPTION	REVISED BY	TOLERANCES X±0.3	ANGLE 1/2°	UNIT mm	PART NAME	PART NO	DWG NO
△						SL19 SPEC DRAWING		WS0205A
△								
△								
△								
△		吳美玉						
△								
△	2005.12.14 換新圖框 重新出圖	吳美玉					SL19-121	